

Overview and Tech Specs

Frame Material.....Alder
 Door Style.....Hollow Core
 Power Supply.....8xAAA Battery
 Interior Exit Mechanism.....Manual Latch
 Locking Device.....Electric Strike
 Hinge.....Overlay
 Mirror Material.....1/8" glass w/safety back

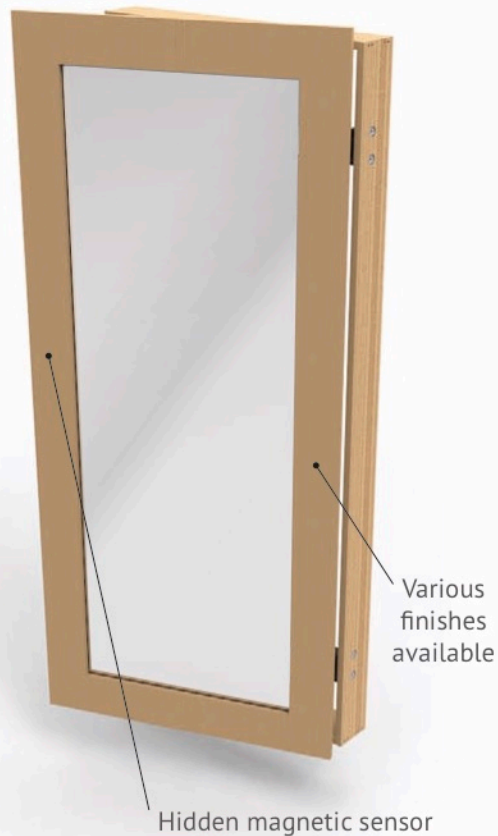

General Dimensions

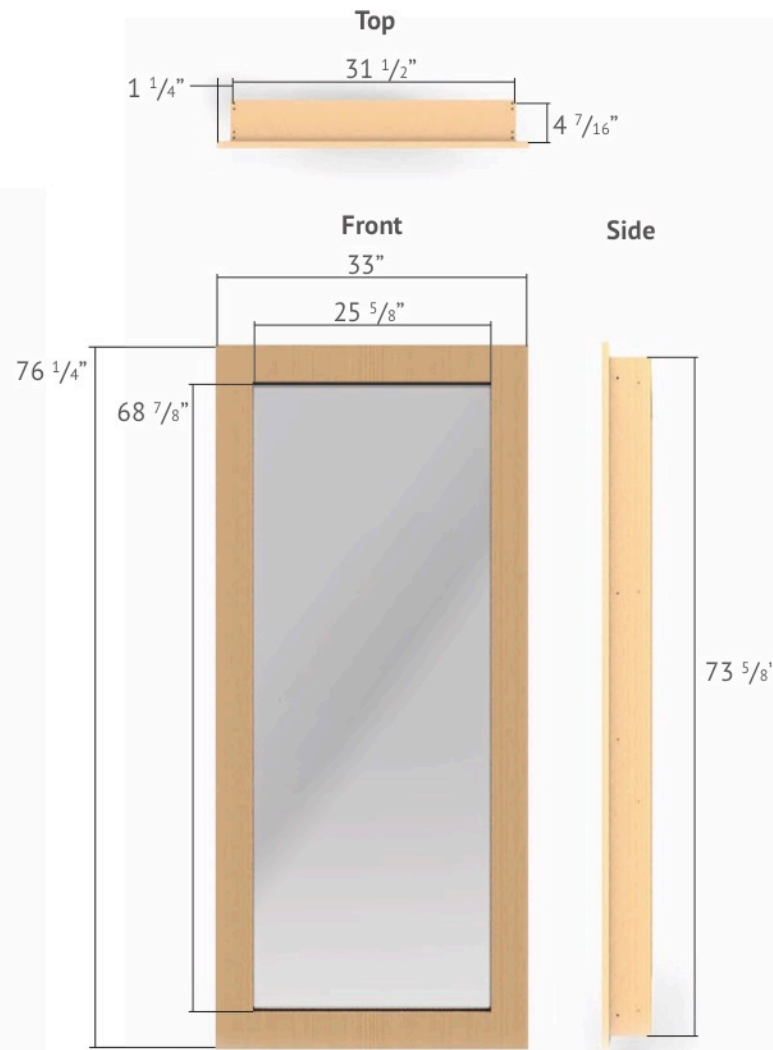

Wall Opening Requirements

Installation of the mirror door requires a wall opening with the below noted dimensions. Opening dimensions may vary by up to 1/8".

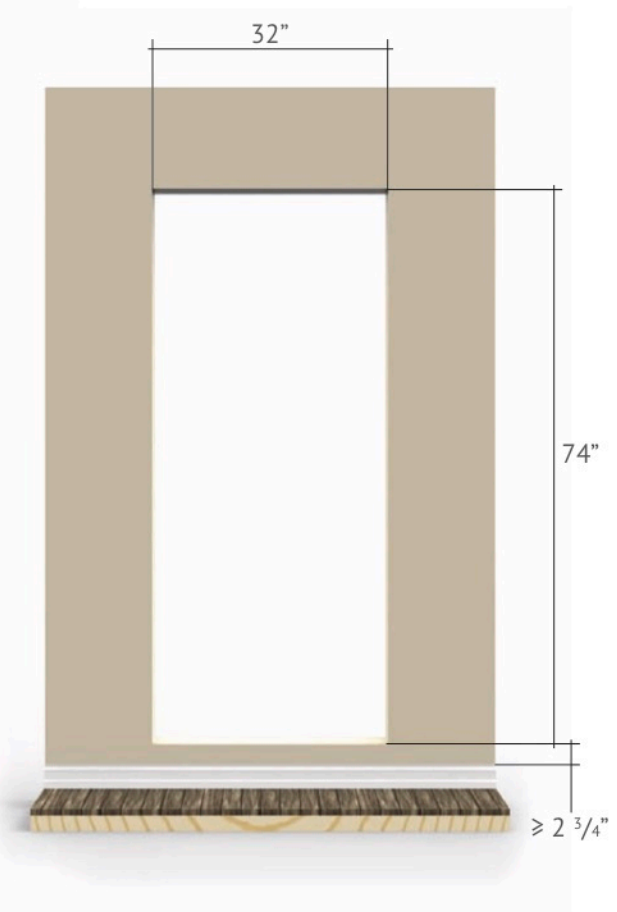

Mirror Installation Steps

Required Tools: 1. Drill with #2 Phillips bit. 2. Level 3. Wood shims.

Step 1

Fit your mirror door into the prepared opening.



Step 2

Level and plumb the door using your level and shims.



Step 3

Secure the door frame to the studs with the included screws using a drill and driver.

